

# R+2

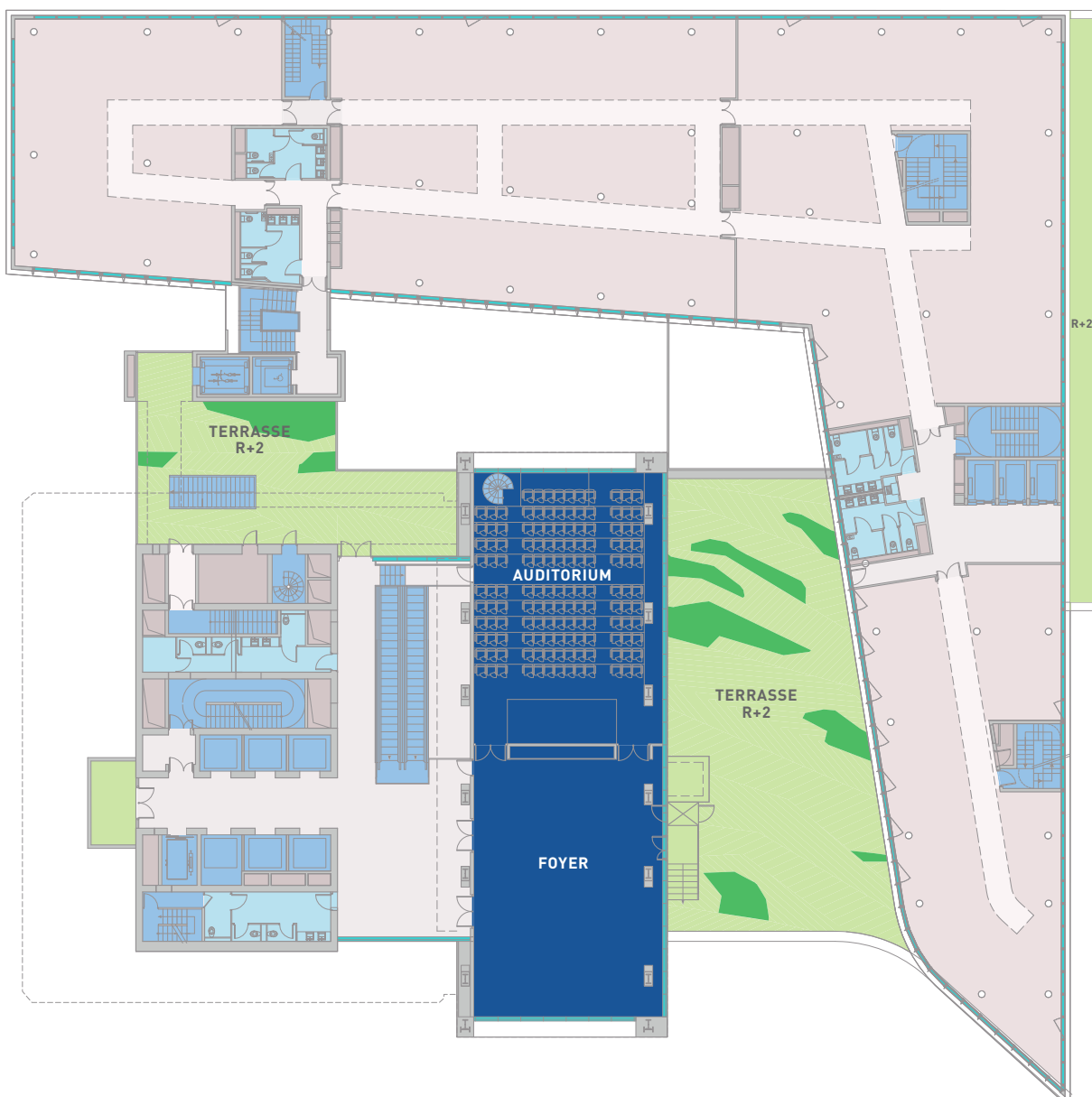

SURFACE : 2 058 M<sup>2</sup>  
POSTES DE TRAVAIL : 120



- |                           |                            |                           |
|---------------------------|----------------------------|---------------------------|
| Circulations verticales   | Bureaux                    | Services                  |
| Circulations horizontales | Sanitaires                 | Jardin / patio / terrasse |
| Espace communs            | Locaux techniques / Divers |                           |